

MIDWAY MILE

INDUSTRIAL CAMPUS

6

PROPERTY INFORMATION

Address	692-710 Prior Ave N. St. Paul, MN 55114
Building Size	126,600 SF
Column Spacing	28' x 20' 20' x 65'
Clear Height	16' - 21'
Net Rental Rates	\$10.00 PSF office \$5.00 PSF warehouse
2021 Cam & RE Tax	\$2.85 PSF

AMENITIES

- Low building operating expenses
- Heavy power, many manufacturing upgrades
- 1/2 mile to BNSF St Paul intermodal yard
- Three blocks to Metro Green Line, Fairview Avenue light rail station
- Excellent access to Highway 280 and Interstates I-94, I-35W and I-35E
- Located in the heart of the Twin Cities metro, just a six minute drive from downtown Minneapolis and St. Paul



Eric Batiza, SIOR
612 217 5123
eric.batiza@am.jll.com

Connor Ott
612 217 6741
connor.ott@am.jll.com



FLOOR PLAN

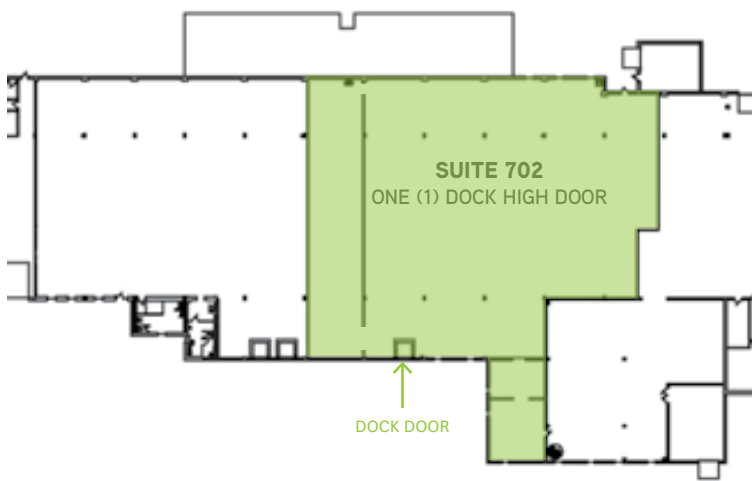

Suite 702

Warehouse: 15,411 SF

Total: 15,411 SF

(1) dock high door



Eric Batiza, SIOR
612 217 5123
eric.batiza@am.jll.com

Connor Ott
612 217 6741
connor.ott@am.jll.com

